



Scan the QR code for
eManual and related
content



Pocket WiFi V4.0

Installation Manual

Version 1.0

www.solaxpower.com

Safety

Description of Labels



CE mark of
conformity



FCC mark of conformity



RCM mark of
conformity



Do not dispose of the
device together with
household waste.

CE DECLARATION OF CONFORMITY

- The product conforms to RF specifications and technical standards. The device complies with DOC declaration.
- The device meets the basic requirements and other relevant provisions of 2014/53/EU directive. The device is allowed to be used in all EU member states.
- Manufacturer: SolaX Power Network Technology (Zhejiang) Co., Ltd. Product type: Pocket WiFi V4.0

FCC RULES

This device complies with part 15 of the FCC Rules.

Operation is subject to the following two conditions:

(1) This device may not cause harmful interference, and
(2) This device must accept any interference received, including interference that may cause undesired operation. Any changes or modifications not expressly approved by the party responsible for compliance could void the user's authority to operate the equipment.

Note: This equipment has been tested and found to comply with the limits for a Class B digital device, pursuant to part 15 of the FCC Rules. These limits are designed to provide reasonable protection against harmful interference in a residential installation. This equipment generates, uses and can radiate radio frequency energy and, if not installed and used in accordance with the instructions, may cause harmful interference to radio communications. However, there is no guarantee that interference will not occur in a particular installation. If this equipment does cause harmful interference to radio or television reception, which can be determined by turning the equipment off and on, the user is encouraged to try to correct the interference by one or more of the following measures:

- Reorient or relocate the receiving antenna.
- Increase the separation between the equipment and receiver.
- Connect the equipment into an outlet on a circuit different from that to which the receiver is connected.
- Consult the dealer or an experienced radio/TV technician for help.

Please scan the QR code below for safety regulations in multiple languages:



Packing List



Dongle x 1



Document

Installation Steps

Before installation, ensure that all power has been cut off for at least 5 minutes.

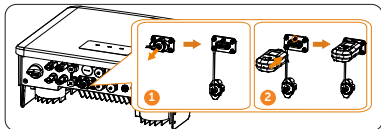

NOTICE!

In step 2, make the circled inserted into the preformed groove.

Communication Requirements

The distance between the router and the equipment should be less than 100 m. However, if there is an obstacle between them, the separation distance should be less than 20 m.

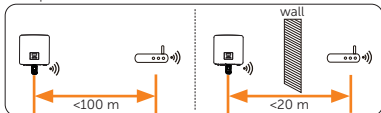

NOTICE!

If the WiFi signal is not strong enough, install a WiFi signal booster at the appropriate location.

WiFi Configuration

1. Scan the left QR code or enter the keyword "SolaXCloud" in the APP Store to download the SolaXCloud APP.
2. Scan the right QR code for *Configuration Guide*.



Download App



Configuration Guide

NOTICE!

If you need to download *Configuration Guide*, please scroll down to the bottom of the web page and click **Download**.

Technical Data

Model	Pocket WiFi V4.0
Power Supply	5 V 50 mA DC
Rated Power	0.5 W
Data Transfer Intervals	5 mins / 10 s (optional)
EIRP Power	18 dBm (Measured Max. Average)
Antenna Gain	0.5 dBi
WiFi Standard	802.11 b/g/n/ax
WiFi Band	2.412-2.472 GHz
BLE Standard	BLE5.2 1M (aid WiFi connection)
Weight	45±10 g

Dimensions	83 × 44 × 26.5 mm
Protection Degree	IP65
Operating Temperature	-30°C ~ +60°C
Wireless Module	WiFi 6, 2.4 GHz
EMC	ETSI EN 301 489-1 V2.2.3: 2019, ETSI EN 301 489-17 V3.2.4:2020 EN 55032:2015+A11:2020, EN 55035:2017+A11:2020EN IEC61000-3-3: 2019+A1:2021, EN 61000-3-3: 2013/A2: 2021/AC: 2022-01
Safety	EN 62368-1:2014+A11:2017
Radio	ETSI EN 300 328 V2.2.2: 2019
Health	EN IEC 62311: 2020, EN 50665: 2017

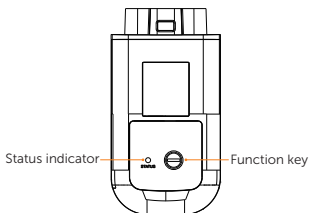

Description of status indicator

Indicator colour	Status	Description
Red	Flash	Inverter connection abnormal
	Always on	Router connection abnormal
Green	Flash	OTA upgrade
	Always on	All connections normal
Red&Green	Flash alternately	Server connection abnormal

Description of function key

Function	Operation	Description
Turn on AP	Press once	The indicator being in red for 200 ms indicates the operation works.

Function	Operation	Description
Restart	Press twice	The indicator being in red for 200 ms twice indicates the operation works.
Factory reset	Long press for more than 5 s	The indicator flashing in red three times indicates the operation works.

NOTICE!

- If you need to enter **LOCAL MODE**, please press the function key once to turn on AP.
- The priority level of status indicator: OTA upgrade > Inverter connection abnormal > Router connection abnormal > Server connection abnormal.

SolaX Power Network Technology (Zhejiang) Co., Ltd.

ADD.: No. 278, Shizhu Road, Chengnan Sub-district, Tonglu County,
Hangzhou, Zhejiang, China
E-mail: info@solaxpower.com

